

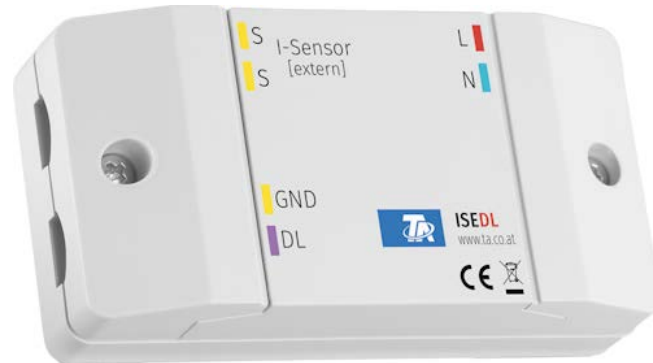

## Power sensor for external folding transformer



This measuring amplifier can be used to measure the voltage and power of any consumer.

The current transformer supplied can measure up to 50 A. 100 A and 400 A current transformers can also be used (available separately).

The phase and neutral conductor for the voltage measurement are connected on the right-hand side of the terminals.

### Electrical connection

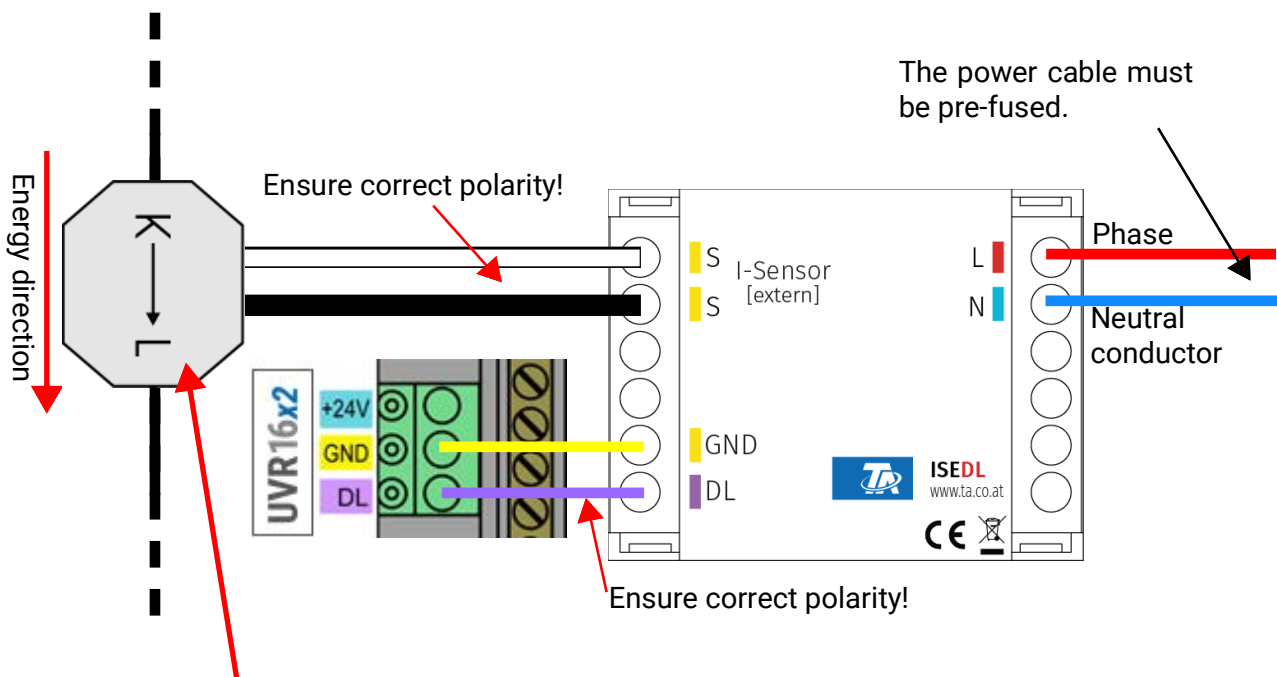

Each external current transformer is labelled with "K -> L" (or P1 -> P2), whereby the **electric current direction must be from K to L** (or P1 to P2) for positive metering.

## Programming

The ISE-DL is included as a CORA device in the programming of the higher ranking controller. It is recommended that programming be performed on the PC with TAPPS2. Use via conventional DL bus is not available. As such, programming via DL input is not possible either.

## Input variables

<i>No input variables for this device</i>
---

## Parameters

<b>Designation</b>	Designation group, designation and index <ul style="list-style-type: none"><li>This designation refers to the CORA device block itself.</li></ul>
<b>Connection</b>	Connection via CORA wireless or CORA-DL
<b>CORA ID</b>	Enter the CORA ID, which can be read from the label on the CORA device
<b>Current transformer</b>	Specifies which current transformer is used. <ul style="list-style-type: none"><li>16 A (internal) for IS-DL</li><li>50/100/400 for ISE-DL and corresponding current transformer</li></ul>
<b>Measured variable</b>	Amperage mA/A

## Output variables

<b>Timeout</b>	Digital signal <b>Yes/No</b> <ul style="list-style-type: none"><li>If <b>Yes</b>: Connection to the device lost</li></ul>
<b>Current</b>	Current with measured variable according to parameter
<b>Value at timeout</b>	<ul style="list-style-type: none"><li>Unchanged: In the event of a timeout, the last measured value remains at the output variable.</li><li>User def.: In the event of a timeout, the output value to be set below is output.</li></ul>

## Dimensions in mm

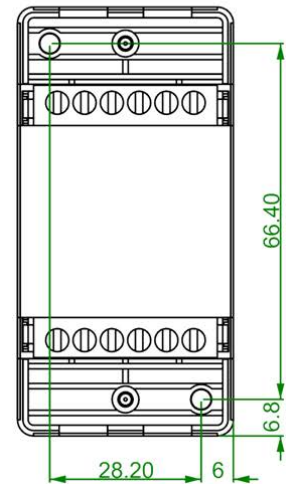
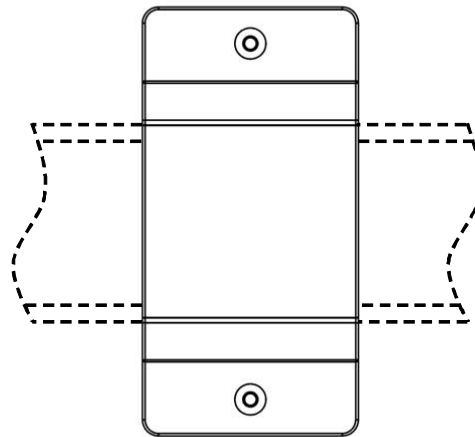
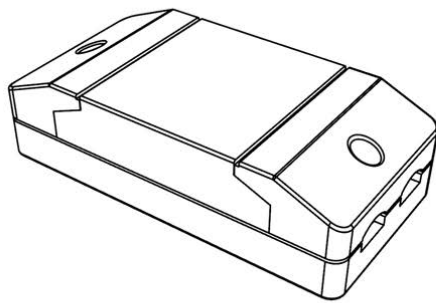
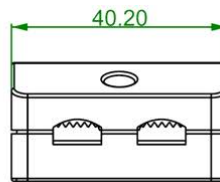
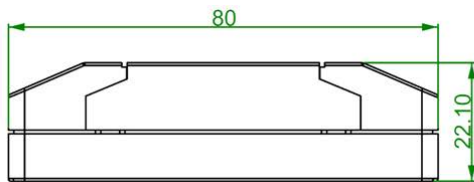

Top-hat rail installation  
(support rail TS35 to  
standard EN 50022)

## Technical data

Accuracy	$\pm 20$ mA
Resolution	0.1 A
Connection	CORA-DL only
DL bus load	30 %

Subject to technical modifications as well as typographical and printing errors. This manual is only valid for devices with the corresponding firmware version. Our products are subject to constant technical advancement and further development. We therefore reserve the right to make changes without prior notice.

© 2025

# EU Declaration of conformity

Document-No. / Date: TA25004 / 24.04.2025  
Company / Manufacturer: Technische Alternative RT GmbH  
Address: A-3872 Amaliendorf, Langestraße 124

***This declaration of conformity is issued under the sole responsibility of the manufacturer.***

Product name: UVR610S, UVR610S-OD, UVR610S-OD-MODB, UVR610K, UVR610K-OD  
Product brand: Technische Alternative RT GmbH  
Product description: Freely programmable universal controller

***The object of the declaration described above is in conformity with Directives:***

2014/35/EU Low voltage standard  
2014/30/EU (11/09/2018) Electromagnetic compatibility  
2011/65/EU (01/10/2022) RoHS Restriction of the use of certain hazardous substances

EN 60730-1:2021-06	Automatic electrical controls - Part 1: General requirements
EN IEC 61000-6-3:2022-06	Electromagnetic compatibility (EMC) - Part 6-3: Generic standards - Emission standard for equipment in residential environments
EN IEC 61000-6-2:2019-11	Electromagnetic compatibility (EMC) - Part 6-2: Generic standards - Immunity standard for industrial environments
EN IEC 63000:2019-05	Technical documentation for the assessment of electrical and electronic products with respect to the restriction of hazardous substances

***Position of CE - label:*** On packaging, manual and type label



Issuer: Technische Alternative RT GmbH  
A-3872 Amaliendorf, Langestraße 124

***This declaration is submitted by***

A handwritten signature in black ink, appearing to read 'Andreas Schneider'.

Dipl.-Ing. Andreas Schneider, General manager,  
24.04.2025

This declaration certifies the agreement with the named standards, contains however no warranty of characteristics.

The security advices of included product documents are to be considered.