

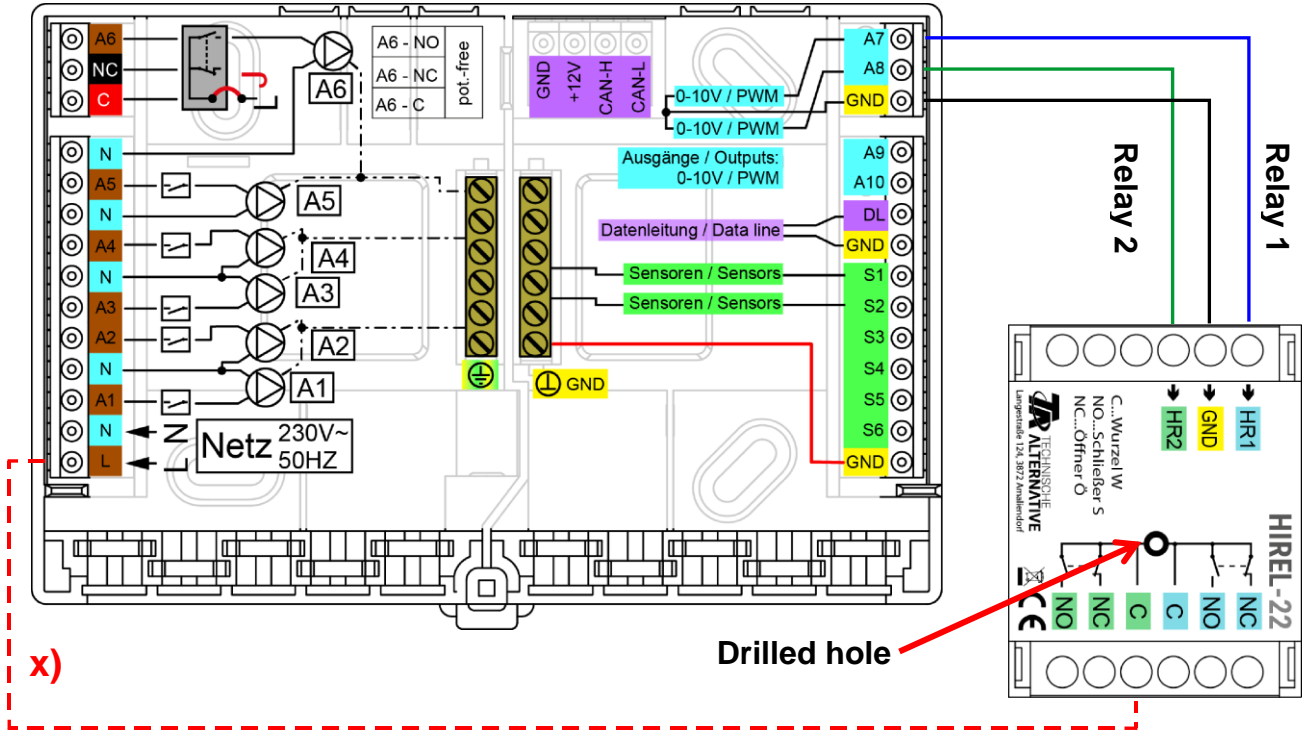

## Auxiliary relay for CAN bus devices

Example: Connection HIREL22 --- RSM 610 for outputs 7 and 8

Program outputs A7 and A8 as switching outputs.



**x)** This connection enables the HIREL22 relay contacts to switch the phase conductor (230 V) to become conductive. As a consequence the relay outputs are no longer potential-free.

### HIREL22 wiring diagram

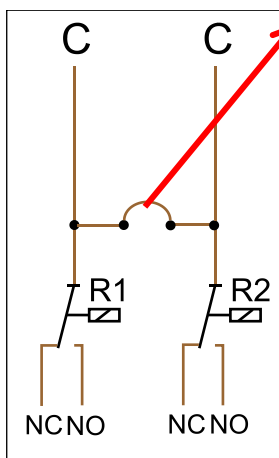

**Drilled hole:** The relay contacts are - **without** connection **x)** - potential-free, for which both roots (**C**) have been connected at the factory. Widening the **hole** between both relays to at least **6 mm** in diameter separates the potential of both outputs across each other in accordance with industry

NC...	Normally closed contact
NO...	Normally open contact
C...	Root

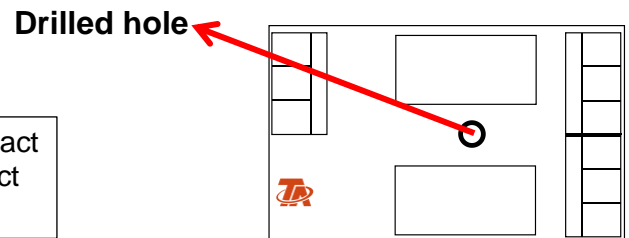

The auxiliary relay can be connected across any two analogue outputs if these are programmed as **switching outputs**.

## Dimensions in mm

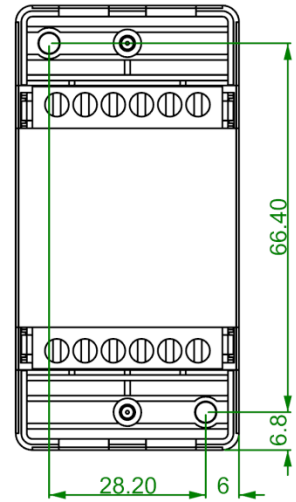
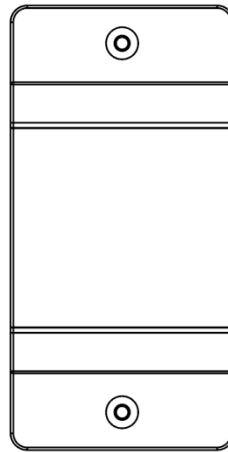
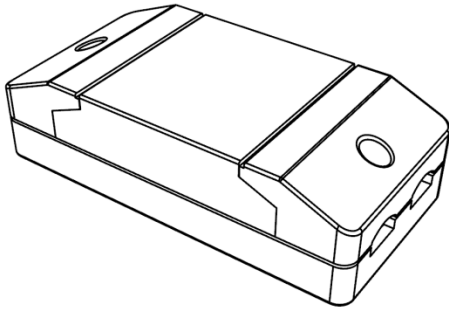
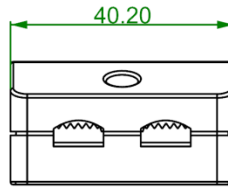
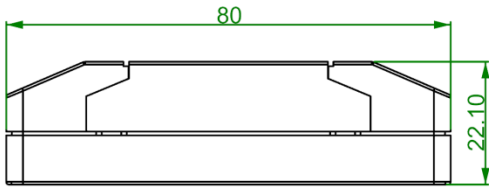

**Max. switching capacity: 230V/3A**

Subject to technical modifications

© 2017